

**TOWN OF ARGYLE, TEXAS
ORDINANCE NO. 2026-06**

AN ORDINANCE OF THE TOWN OF ARGYLE, TEXAS, AMENDING THE CODE OF ORDINANCES CHAPTER 12, TRAFFIC & VEHICLES, ARTICLE 12.02 SPEED LIMITS, BY AMENDING THE LIST OF SCHOOL ZONES TO INCLUDE ONE ADDITIONAL SCHOOL ZONE ALONG FM 407 WEST AND ONE ADDITIONAL SCHOOL ZONE ALONG CRAWFORD ROAD; AUTHORIZING THE ERECTION OF TRAFFIC REGULATION SIGNS; REPEALING CONFLICTING ORDINANCES; PROVIDING A PENALTY OF FINE NOT TO EXCEED THE SUM OF TWO HUNDRED DOLLARS (\$200.00) FOR EACH OFFENSE AND A SEPARATE OFFENSE SHALL BE DEEMED COMMITTED, EACH TIME A VIOLATION OCCURS OR CONTINUES; PROVIDING A SEVERABILITY CLAUSE; DECLARING AN EMERGENCY; AND PROVIDING AN EFFECTIVE DATE.

WHEREAS, the Town of Argyle is a Type A General Law Municipality located in Denton County, created in accordance with provisions of the Texas Local Government Code and operating pursuant to the enabling legislation of the State of Texas; and

WHEREAS, Section 545.351 of the Texas Transportation Code, as amended, regulates maximum speed requirements; and

WHEREAS, Section 545.352 of the Texas Transportation Code, as amended, provides for prima facie speed limits in the Town of Argyle; and

WHEREAS, the Town of Argyle is authorized to establish and enforce speed limits which are below the prima facie limits in school zones based on the special hazard they represent; and

WHEREAS, school zones constitute a special hazard due to pedestrian traffic during the hours of the opening and closing of schools; and

WHEREAS, the Town of Argyle deems the passage of this ordinance as necessary to protect the public health, safety, and welfare; and

WHEREAS, the Town Council of the Town of Argyle has complied with all necessary legislative prerequisites to the passage of this ordinance.

NOW, THEREFORE, BE IT ORDAINED BY THE TOWN COUNCIL OF THE TOWN OF ARGYLE, TEXAS:

SECTION 1: All matters stated hereinabove are found to be true and correct and are incorporated herein by reference as if copied in their entirety.

SECTION 2: That Chapter 12, Article 12.02 of the Code of Ordinances of the Town of Argyle, Texas, is hereby deleted in its entirety, and a new Chapter 12, Article 12.02, is added as shown in Exhibit A.

SECTION 3: That all ordinances or any parts thereof in conflict with the terms of this ordinance shall be and hereby are deemed repealed and of no force or effect; provided, however, that the ordinance or ordinances under which the cases currently filed and pending in the Municipal Court of the Town of Argyle, Texas, shall be deemed repealed only when all such cases filed and pending under such ordinance or ordinances have been disposed of by a final conviction or a finding not guilty or nolo contendere, or dismissal.

SECTION 4: If any section, article, paragraph, sentence, clause, phrase or word in this ordinance, or application thereto any person or circumstances is held invalid or unconstitutional by a Court of competent jurisdiction, such holding shall not affect the validity of the remaining portions of this ordinance; and the Town Council hereby declares it would have passed such remaining portions of the ordinance despite such invalidity, which remaining portions shall remain in full force and effect.

SECTION 5: In addition to and accumulative of all other penalties, the Town shall have the right to seek injunctive relief for any and all violations of this Ordinance.

SECTION 6: In order to protect the public interest, comfort, and general welfare, this Ordinance shall take effect immediately from and after its passage and publication as required by law.

SECTION 7: The Town Secretary of the Town of Argyle is hereby directed to publish the caption, penalty clause, and the effective date clause in the official Town newspaper in every issue for two days as authorized by Section 52.011 of the Texas Local Government Code.

PASSED AND APPROVED BY THE TOWN COUNCIL OF THE TOWN OF ARGYLE, TEXAS ON THIS THE 20th DAY OF JANUARY 2026.

APPROVED:



Ronald Schmidt, Mayor

ATTEST:

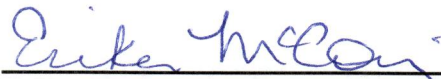

Erika McComis, Town Secretary



Exhibit A

Chapter 12 - TRAFFIC AND VEHICLES ARTICLE 12.02. SPEED LIMITS

ARTICLE 12.02. SPEED LIMITS¹

Sec. 12.02.001 Established.

- (a) No person shall drive, as defined by state law, a motor vehicle, a motorcycle, bicycle, motor driven cycle, motor assisted cycle or any other vehicle of any kind (hereinafter collectively referred to as "vehicle") on a public street, alley or highway within the corporate limits of the town at a speed greater than is reasonable and prudent under the circumstances then existing and having regard to the actual and potential hazards then existing. The limits specified in this article shall be the lawful speed limits and any speed in excess of the limits so specified and established as authorized by law shall be prima facie evidence that the speed is not reasonable or prudent and that it is unlawful. In every event speed shall be controlled as may be necessary to avoid colliding with any person, vehicle or other conveyance on or entering the public street or public alley, in compliance with legal requirements and the duty of all persons to use due care.
- (b) Unless a special hazard exists that requires a slower speed for compliance with the law, the following speeds are lawful: 30 miles per hour in an urban district on a street other than an alley and 15 miles per hour in an alley.
- (c) Upon the basis of an engineering and traffic investigation heretofore made as authorized by the provisions of section 169, Tex. Rev. Civ. Stat. Ann. art. 6701d, Uniform Act Regulating Traffic on Highways, the following speed limits hereafter indicated for vehicles are hereby determined and declared to be prima facie reasonable and safe and such speed limits are fixed at the rate of speed indicated for vehicles traveling upon the named public streets and highways or parts thereof. The streets and highways hereby regulated and the maximum prima facie speed limits thereof are as follows:

Street	Speed Limit
Rolling Acres Drive	20 miles per hour
Whispering Trails	20 miles per hour

The town administrator, or his designee, is hereby directed to post signs at appropriate locations along the above roads indicating that required speed limits.

- (d) Upon the basis of a traffic investigation heretofore made as authorized by the provisions of V.T.C.A., Transportation Code § 546.356, the following prima facie speed limit hereafter indicated for vehicles are hereby determined and declared to be reasonable and safe; and such speed limits are hereby fixed at the rate of speed indicated for vehicles traveling upon the named streets and highways, or parts thereof.
 - (1) No motor vehicle shall be operated along and upon U.S. Highway 377, within the corporate limits of the town in excess of 50 miles per hour.
 - (2) No motor vehicle shall be operated along and upon Farm-to-Market Road 1830 within the corporate limits of the town in excess of 50 miles per hour.

¹State law reference(s)—Authority to establish or alter prima facie speed limits, V.T.C.A., Transportation Code § 542.202(12); speed restrictions, V.T.C.A., Transportation Code § 545.351 et seq.; authority of municipality to alter speed limits, V.T.C.A., Transportation Code § 545.356.

- (3) No motor vehicle shall be operated along and upon Country Club Road beginning at said point being the east town limits of the town thence in a westerly direction along Country Club Road for a distance of 1.0 miles approximately to the intersection of US Hwy. 377, a maximum speed limits of 45 miles per hour.
 - (4) No vehicle shall be operated along and upon Farm-to-Market Road 407, within the corporate limits of the town, in excess of the following prima facie speed limits:
 - (A) Beginning at said point being the east town limits of the town thence in a westerly direction along Farm-to-Market Road 407 for a distance of approximately 2.703 miles, a maximum speed limit of 55 miles per hour;
 - (B) Thence continuing in a westerly direction along Farm-to-Market Road 407 for a distance of approximately .5 miles, a maximum speed limit of 45 miles per hour; and
 - (C) Thence continuing in a westerly direction along Farm-to-Market Road 407 for a distance of approximately 1.735 miles, and ending at a point being the west town limits of the town, a maximum speed limit of 55 miles per hour.
 - (5) No vehicle shall be operated along and upon Robson Ranch Road, within the corporate limits of the town, in excess of the following prima facie speed limits beginning at said point being the west town limits of the town thence in a easterly direction along Robson Ranch Road for a distance of approximately 2,750 feet to IH 35W, a maximum speed limit of 50 miles per hour.
- (e) The following school zone speed limits and effective days and times hereafter indicated for vehicles are hereby determined and declared to be prima facie, reasonable and safe. Such speed limits are fixed at their rate of speed and effective day and times indicated for vehicles traveling upon the following public streets and roadways or parts thereof and shall be designated by official school zone speed limit signs located on said streets and roadways during the hours and days so indicated and designated:

<u>School Zones</u>	<u>Maximum Speed Limit</u>	<u>Effective</u>
(1) Harrison Lane (on the west side of Harrison Lane approximately 200 feet north of the driveway serving the parking lot on the north side of the school and on the east side 20 feet south of Hearth Terrace.)	20 mph	6:45 a.m.—7:45 a.m. 2:30 p.m.—3:30 p.m.
(2) Crawford Road (that portion of Crawford Road extending 300 feet west of the center point of the entrance to the school, and 350 feet east of the center point of the entrance to the school.)	20 mph	7:30 a.m.—8:30 a.m. 3:10 p.m.—4:10 p.m.
(3) FM 407 W (that portion of FM 407 W extending 1250 feet west of the center point of Woods Drive, and 400 feet east of the center point of Woods Drive.)	35 mph	When Flashing

- (f) The following residential streets are not officially designated or marked highway or roads of the state highway system, and the governing body has determined that the prima facie speed limit on the highway is

unreasonable due to special hazards. The town council has declared a lower speed limit of 25 miles per hour on the following roads:

- (1) Redbud Street;
- (2) Oak Street;
- (3) Willow Street;
- (4) Peyton Place;
- (5) Old Town Boulevard North;
- (6) Old Town Boulevard South;
- (7) Highland Circle;
- (8) Boonesville Bend;
- (9) Ellison Trace;
- (10) Nora Lane;
- (11) Myrtle Lane;
- (12) Big Sky Way;
- (13) Trigger Trail;
- (14) Travelers Terrace;
- (15) Pegasus Ridge;
- (16) Comanche Run;
- (17) Appaloosa Run;
- (18) 5T Ranch Road;
- (19) Aberdeen Boulevard;
- (20) Carrington Drive;
- (21) Glen Innes Drive;
- (22) Craig Court;
- (23) Kirkpatrick Court;
- (24) Dundee Court;
- (25) Sterling Drive;
- (26) Craigmore Drive;
- (27) Perth Court;
- (28) Glendale Drive;
- (29) Telford Drive;
- (30) Blue Horizon Way;
- (31) High Point Drive;
- (32) Foxglove Hill;

-
- (33) Rustic Trail;
 - (34) Artesian Drive;
 - (35) Driftwood Lane;
 - (36) Rain Lily Lane;
 - (37) Quaint Pond Lane;
 - (38) Waterbrook Parkway;
 - (39) Village Green Drive;
 - (40) Dove Falls Drive;
 - (41) Misty Lane;
 - (42) Swift Creek Road;
 - (43) Waters Edge Drive;
- (g) The town administrator, or his designee, is hereby authorized to have the proper traffic signs erected, constructed, and placed at such points along said highways, streets or alleys, or portions hereof under construction, maintenance or repair so that travelers will be reasonably notified of said traffic regulations.
 - (h) Notwithstanding anything contained in this article to the contrary, the maximum permissible speed limit on any street or roadway within the town shall not exceed the speed designated on temporary signs posted by the town to specify a lower reasonable and prudent speed because of street repairs, construction, emergency conditions or other actual or potential hazards then existing on such street and roadways.
 - (i) Any person violating any of the provisions of this article shall be deemed guilty of a misdemeanor and upon conviction thereof shall be fined in a sum not to exceed \$200.00 and a separate offense shall be deemed committed each time a violation occurs.
- (Ord. No. 2018-09, 4-24-18; Ord. No. 2018-20, § 2, 11-27-18; Ord. No. 2019-07, § 2, 4-23-19; Ord. No. 2020-06, § 2, 3-24-20; Ord. No. 2023-21, § 1(Exh. A), 6-26-23)

EXHIBIT B

FM 407

DEVELOPMENT	
RES. SIGHT DISTANCE	
BALL BANK OR ADVISORY SPEED	
CURVES OVER 2°	
GRADES OVER 3%	
SURFACE WIDTH AND TYPE	
R.O.W. AND RDBD. WIDTH	
ACCIDENTS	
ZONE LENGTHS (MILES)	
ZONE SPEEDS (M.P.H.)	
EXISTING SPEED	55 MPH

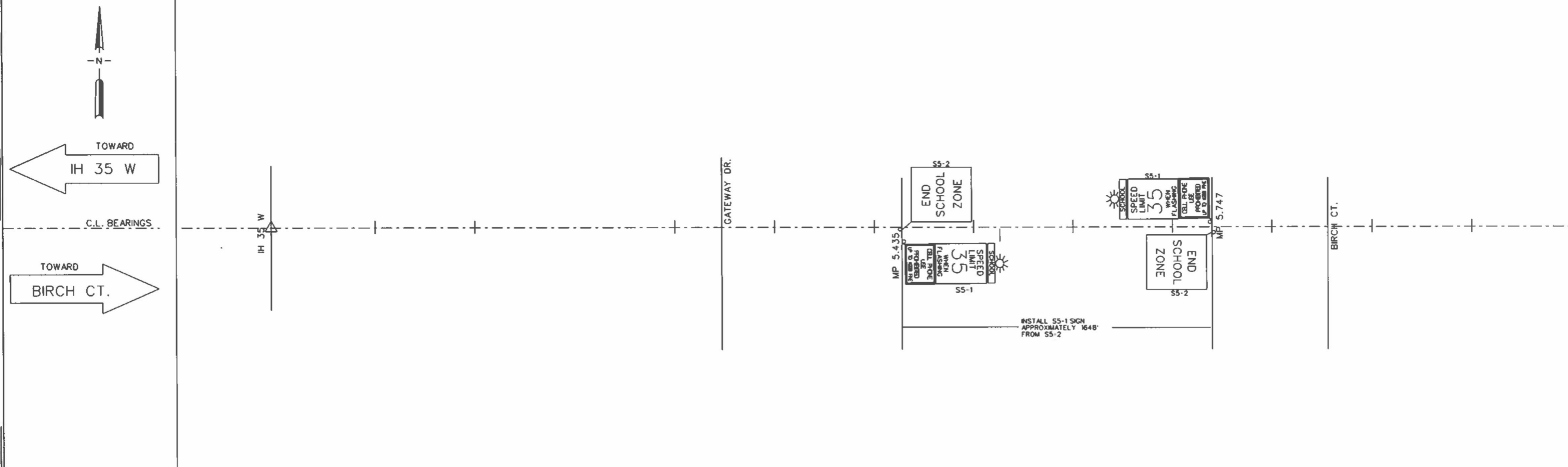

EXISTING SPEED	55 MPH
ZONE SPEEDS (M.P.H.)	
ZONE LENGTHS (MILES)	
ACCIDENTS	
R.O.W. AND RDBD. WIDTH	
SURFACE WIDTH AND TYPE	
GRADES OVER 3%	
CURVES OVER 2°	
BALL BANK OR ADVISORY SPEED	
RES. SIGHT DISTANCE	
DEVELOPMENT	

DISTRICT: DALLAS	COUNTY: DENTON	MINUTE NO.:	DATE: / /
HIGHWAY: FM 407	CITY: DENTON	REPLACES:	DATE: / /
DATE OF STUDY 12-12-25	SCALE 1" = 0.1 MILES	REPLACED BY:	DATE: / /
		CANCELLED BY:	DATE: / /

LIMITS OF ZONE							
SECTION ONE				SECTION TWO			
STA. OR M.P.	CONT. AND SECT.	PROJECT	MILES	STA. OR M.P.	CONT. AND SECT.	PROJECT	MILES
BEGINS	0 + 00		()	BEGINS		()	
ENDS	0 + 00		()	ENDS		()	

LEGEND

- 85 PERCENTILE SPEED
- TOP SPEED MEASURED
- NUMBER OF CARS CHECKED
- FATAL ACCIDENT
- PERSONAL INJURY ACCIDENT
- PROPERTY DAMAGE ACCIDENT
- INDICATES SECTION ZONED BY COMMISSION MINUTE
- SIGNALIZED INTERSECTION
- TRIAL RUN

SCHOOL ZONE
 CONT. 1310 SEC. 01
 LIMITS: FROM GATEWAY DR. TO BIRCH CT.
 ARGYLE ELEMENTARY AND
 MIDDLE SCHOOL

SHEET 1 OF 1

Texas Department of Transportation

SCHOOL FLASHER
 DENTON COUNTY
 FM 407

DESIGN TEAM	FED. NO. (DIV. NO.)	FEDERAL AID PROJECT NO.	SHEET
	STATE	STATE DIST. NO.	COUNTY
CHECKED	CONTROL NO.	SECTION NO.	JOB NO. HIGHWAY NO.

EXHIBIT C



Sam Davis Rd

Sam Davis Rd

Sam

3rd St

35W

407

Corral City

Proposed Sch

Argyle ISD B

407

407